

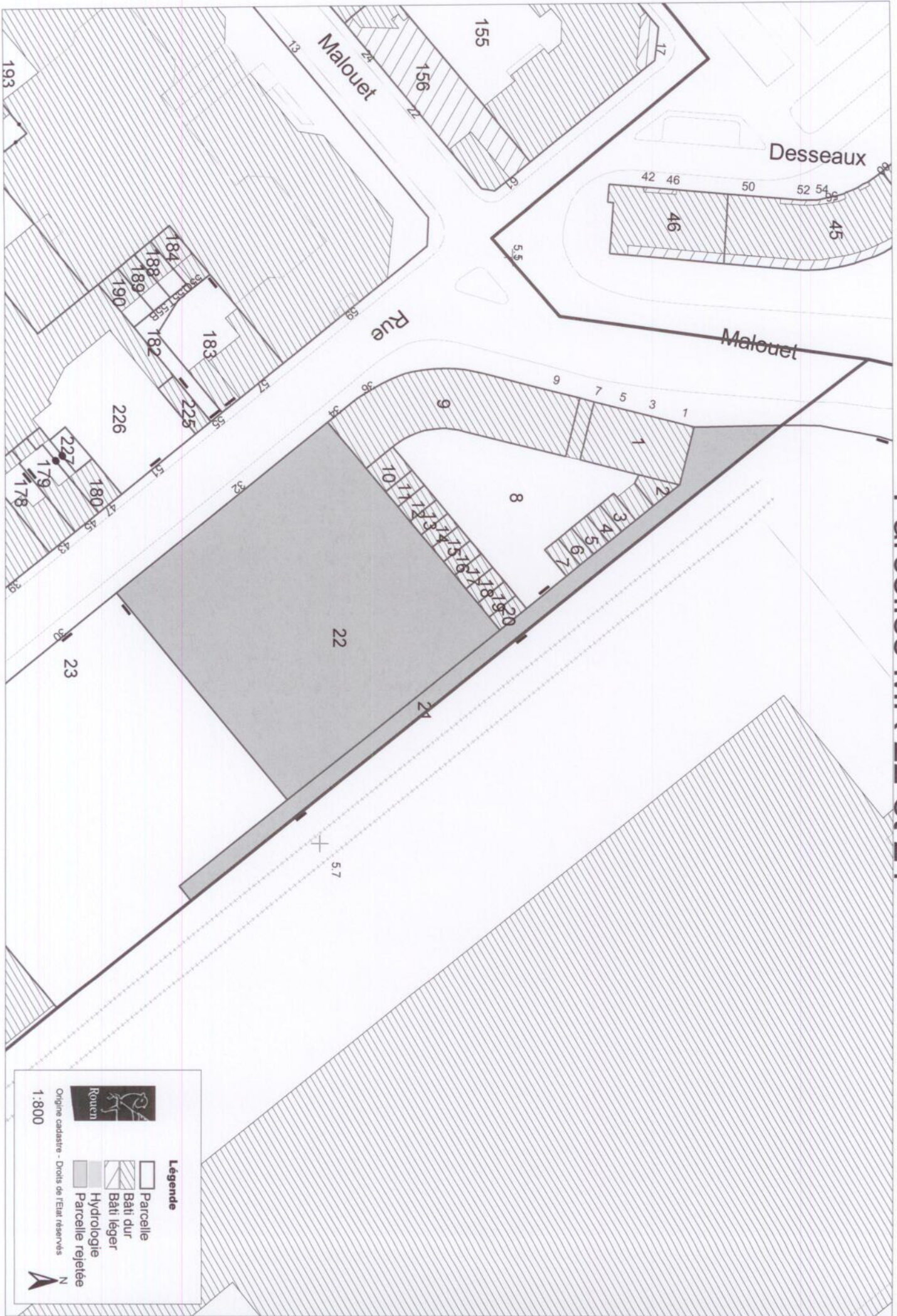





# Parcelles MR 22 et 21



**Legende**

-  Parcelle
-  Bâti dur
-  Bâti léger
-  Hydrologie
-  Parcelle rejetée

Origine cadastre - Droits de l'Etat réservés

1:800

 N



# Parcelles MR 22 et 21

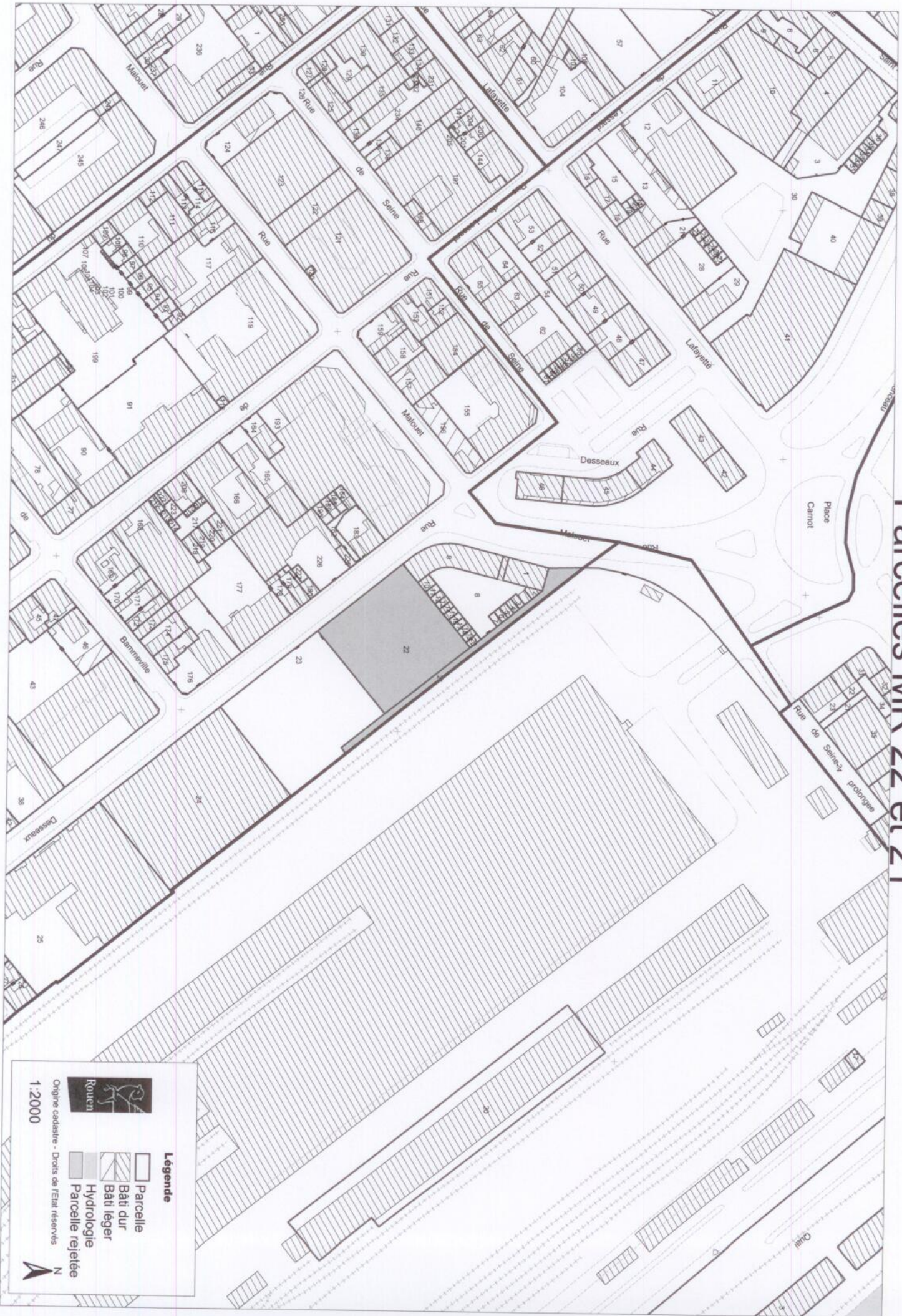

**Legende**

- Parcelle
- Bâti dur
- Bâti léger
- Hydrologie
- Parcelle rejetée

Routem

Origine cadastrale - Droits de l'Etat réservés

1:2000

N